

SELF ADHESIVE ACRYLIC

FOTOPANELS

Create eye catching photo displays in seconds

Print ➔ **Peel** ➔ **Stick**

Fotospeed FOTOPANELS are a simple and effective way to display your images either free standing or hanging on a wall.

Apply the face of your image to the crystal clear, adhesive back of the FOTOPANEL and you're ready to go. FOTOPANELS are available in a variety of sizes and come with an acrylic stand.

Once you have decided which size you require your next choice is paper type. The most important attribute of the paper is the surface. We strongly recommend you use a paper with as smooth a surface as possible. Any texture can result in tiny bubbles appearing between the paper surface and the adhesive. This is known as 'silvering'.

We recommend the following papers:

Matt Infinity 265 // PF Gloss 270 // Matt Ultra 240

Fotospeed
for every print



NEW PAPER

Matt Infinity 265

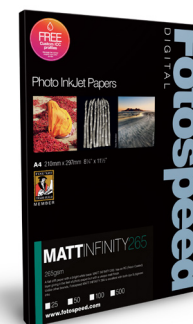

Matt Infinity 265 has an ultra smooth surface and has been designed specifically for face mounting, making it the perfect paper to use with Fotospeed FOTOPANELS.

Available from www.fotospeed.com
Search 'Matt Infinity 265'

1

Sizing your image for print



When preparing your image for a FOTOPANEL make sure you increase the size of the printed image by 2mm in every direction. By doing this you allow yourself a slight tolerance when sticking down. This will then allow you to trim the image to the edge of the FOTOPANEL and will give you a wonderful border-less edge.

If your image is not borderless make sure you add a stroke line 2mm bigger, in every direction.

2

Preparing your FOTOPANEL



Once you have your print, trim it out to the edge of the image or to the stroke line. This gives you a print which is easier to handle.

Available from www.fotospeed.com
Search 'Olfa Knives'

3

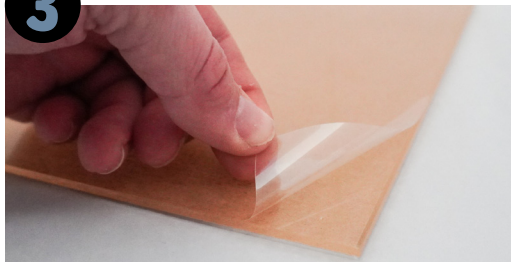

Now lift one corner of the release paper on the FOTOPANEL and fold back exposing the adhesive along the shortest edge.

4

Applying your image



Take your print, line up the shortest edge with the exposed adhesive and press down. You can now slowly remove the rest of the release paper and gently press the print down.



We recommend you use a print squeegee to ensure no air is trapped.

Available from www.fotospeed.com
Search 'Print Squeegee'

5

Finishing



The final stage is trimming the image to size. Take your knife and using the edge of the FOTOPANEL as a guide trim off the excess print.

You can now remove the brown protective layer from the front of the FOTOPANEL and display



**Check out our
video instructions**

www.youtube.com/@FotospeedUK